

# YB- Series High Speed Transfer Pump



## ● Summary

YB series sliding vane pump is with by-pass valve built-in. The pump uses a rotor with sliding vanes to drive the liquid transfer. The material of construction is nodular cast iron with self-lubricating vanes. Due to its superior performance, the pump can handle viscous and volatile liquid and require less horsepower than other equivalent pumps. The pump has its obvious advantage in the transmission of high flow at low revolution.

### PERFORMANCE DATA

Model	YB-50	YB-65	YB-80	YB-100
Rated Speed	640RPM	640RPM	640RPM	640RPM
Power(HP)	3.0	5.0	10	25
Power(KW)	2.2	4	7.5	18.5

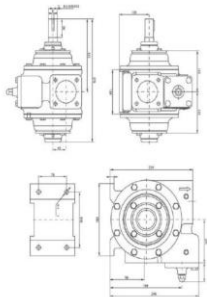

## ● Flow Rate

Model	Size/Flow Rate/Speed	650RPM		650RPM		650RPM		650RPM		650RPM		650RPM	
		G/mm	L/min	G/mm	L/min	G/mm	L/min	G/mm	L/min	G/mm	L/min	G/mm	L/min
YB-50	50mm/2"	80	300	72	270	64	240	56	210	48	180	40	150
YB-65	65mm/2.5"	132	500	123	465	114	430	103	390	93	350	82	310
YB-80	80mm/3"	265	1000	243	920	222	840	200	760	180	680	160	600
YB-100	100mm/4"							505	1900			405	1530